

A Charivari Gone Bad

In a July 6, 1924 article that appeared in the Wisconsin State Journal William F. Pierstorff, who was then living in Mount Horeb and had been a long-prominent citizen of Middleton, former sheriff of Dane County and former chairman of the county board of supervisors, told the story of a famous tragedy that he was witness to. In addition records on file in the MHAHS archive further flesh out Pierstorff's recollections.

The tragedy William recalled was the killing of young Theron Eusebius Dryden, also known as Seeb, at a charivari held on Sept. 11, 1866. The suspected killer was David Holton, who kept a tavern at Brackenwagon's Corner just outside and west of the present village of Mount Horeb on the north side of the road (Highway 78 and ID intersection). This building was torn down in approximately 1922.

At the time of the incident Mount Horeb consisted of just a few houses and a church building at the crossroads near what is today the Union Cemetery (the round-about).

According to Pierstorff, Holton was a quick-tempered man who had a granddaughter named Ellen Clark, said to be an orphan, living with him. Holton arranged to have Ellen marry a visiting stock buyer, James Williams. Williams who was said to have been 45 years old, and she 18. They were married by Oliver "Ole" Heg, a justice of the peace and tenant on Holton's place.

The boys of the neighborhood, several of whom were also fond of the young Ellen, along with Mr. Pierstorff, decided to have a charivari. The party, led by Seeb Dryden who was the son of an early area settler, grew to more than a dozen men. It was agreed

among the boys that it was nothing more than fair, under the circumstances, that Williams, who was taking a nice girl from the neighborhood, should pay the boys \$5 for a treat. A note was written by a man named Hubbell directed to Williams stating the terms of their wishes. It was a moonlit night (in other accounts a cloudy night) and the party headed first to Brackenwagon's store where they drank beer before going to the Holton home for their planned surprise on the newly married couple. The group arrived at the Holton home at 9:30 p.m. with note in hand and knocked on the door three times before getting a response from Holton, who refused to open the door of his house.

As was custom at these events the men of the party held a council of war and sent young Dryden and a son of Ira Isham to parley with him. They stood one on each side of the door, and when Holton opened it they said they had a letter for him. Holton became agitated, raised a gun and shot down Dryden and also wounded Isham. One account claims that Holton rushed out and beat the fallen Dryden with a stick of wood, whereupon Heg (the preacher who married the couple and resident at the house) and others came to Dryden's aid and carried him into Heg's rooms. Another account states that Hubbell grabbed the gun out of Holton's hands which caused Holton to grab Hubbell's leg where he was then dragged to the house-yard gate as Hubbell tried to escape. Dryden had received the larger part of a load of shot and died four days afterward, although six physicians from the surrounding country were called to attend him. At one point the young Dryden was in such pain that four men were called upon to hold him down. The killing made



Jar of shell casings gathered at the charivari for the wedding of Elmer and Ruth Gorden of Verona. The Gordens were married Aug. 16, 1927. (MHAHS Museum collections 1985.54.3)

Continued on page 2

a great sensation in the neighborhood, and Dryden's funeral was one of the largest ever held. Holton was arrested after the shooting, but jumped bail and fled; he was later arrested in Illinois and tried at Madison for murder.

Holton was finally brought to trial in April 1868. The result of the trial was a disagreement with eight jurors voting for conviction and four for acquittal. The case was finally dismissed and this ended the disputes growing out of this sad affair. The marriage that caused the tragedy also turned out badly and the girl spent a very short time living with Williams. Holton and Williams fled the country and with Holton financially ruined by the affair died within a year from the date of his trial.

What is a Charivari?

Charivaris in Europe date back to the Middle Ages and the term is French after their folk customs in which the community gave a noisy, discordant mock serenade, also pounding on pots and pans at the home of newlyweds. The loud public ritual evolved to a form of social coercion, for instance, to force an as-yet-unmarried couple to wed. Charivaris were especially common in small rural communities. This practice came to Southwestern Dane County with the immigrants who settled here. Evidence and written and verbal descriptions of local charivaris include the banging on pots and pans, ringing of cowbells, loud singing and firing of shotguns.

In some cases the crowd took the event further than waking the couple in the middle of the night, when they employed such antics as throwing the newlyweds into a horse tank or forcing the couple to offer wine or treats to the revelers.

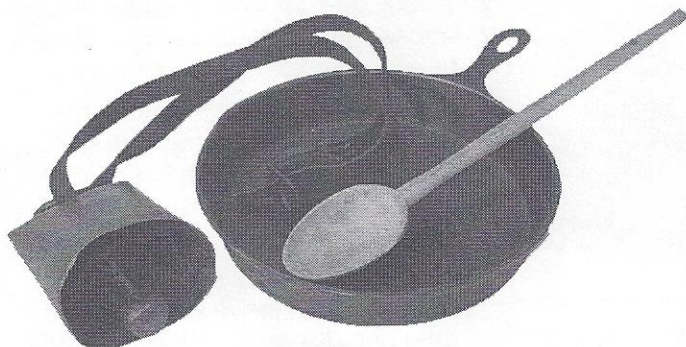

Cow bells and skillets pounded with a wooden spoon were among the noisemakers used during a charivari (MHAHS collections)

High School Annuals Tell More than School Memories

The archives contains an extensive collection of Mount Horeb High School annuals, commonly known as the Berohbok (Horeb spelled backward). The books in the collection date from 1913 to 1990.

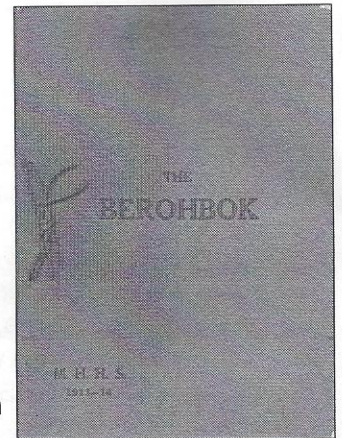

Berohbok 1913-1914

The rare first edition published by the junior class in 1913-14 was dedicated to Miss Lela Verne Parfrey. Its pamphlet style format of pages tied with a decorative cord states in its foreword: "In preparing this little book, we have had many a difficulty to overcome and many a problem to solve. We had no traditions or customs to follow. Ours has been a task of blazing the trail, for this is the very first Berohbok. However, we hope that our readers will pass over our shortcomings and only look forward to the many and better Berohboks of the future. ..." The writers of this first book could not have imagined that their basic inspiration still would be in existence 100 years later.

The covers of these annual publications reflect the influence of American history and regional popular culture and design through the decades. The 1915 and 1916 editions have Arts and Crafts-style covers. On the 1919 edition there is a patriotic banner symbolizing the end of World War I. In the 1930s the books are cheaply made due to the effects of the Great Depression. The 1934 copy has a futuristic skyscraper and a dirigible representative of the 1933-34 Chicago World's Fair. There are eagles on the covers of those published during World War II; Wisconsin's state capitol appears on the cover of the 1948 edition that celebrates the state's centennial, while Mickey and Minnie Mouse appear on the 1949 copy. The war and early postwar years also contain cheaply fashioned books due in part to rationing. A Native American and accompanying design appears in the mid-1940s indicating that the school may have been testing the waters for a new mascot.

The Mount Horeb Area Historical Society

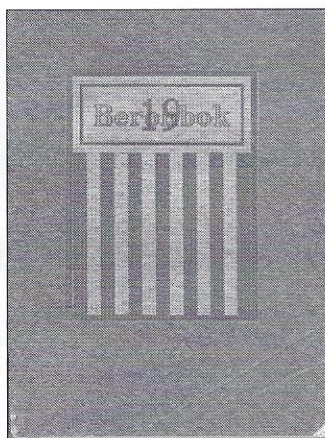

Berohbok 1919

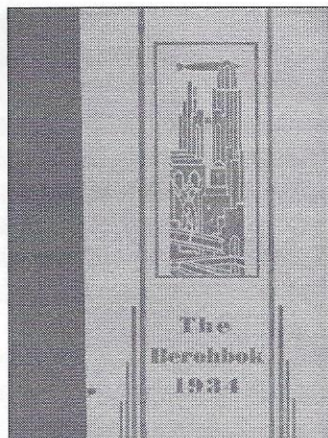

Berohbok 1934

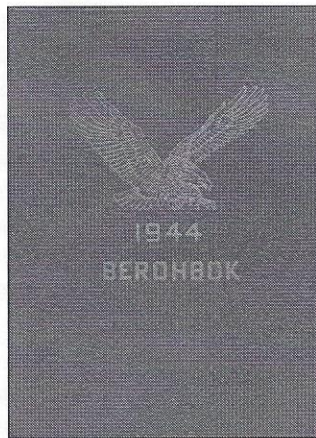

Berohbok 1944

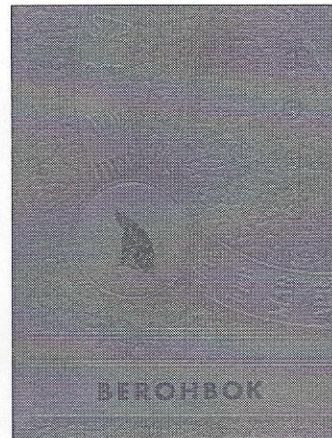

Berohbok 1956

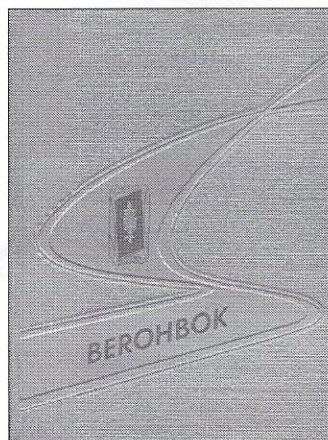

Berohbok 1963



Berohbok 1978

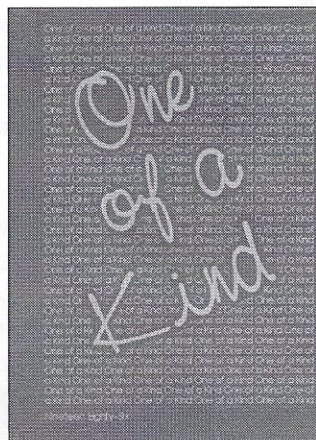

Berohbok 1986

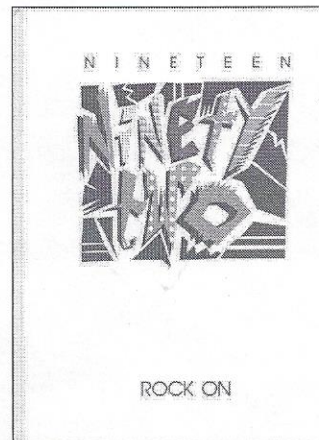

Berohbok 1992

Padded covers become popular in the mid 1950s and early 1960s, with one being a classy gold metallic version. The 1960 book has a world theme on its cover and interior. Mid-century artistic designs are found on the covers of the 1960s. The 1969 through 1971 editions feature the fashionable earthy colors of avocado green, bitter-sweet orange and goldenrod yellow. The 1976 edition's dark blue cover sports a U.S. Bicentennial design. Two separate years in the 1970s have cover designs that contain ecological and environmental themes reminiscent of the Earth Day movement. The 1980s versions include trendy sayings from songs and everyday buzz phrases, like "One of a Kind," and "Celebrate." In the 1990s we see "The Big Picture," "Rock On," "What's the Question" and "Been There Done That."

A Viking does not appear on the cover until 1956 and seems quite fierce in appearance. This Viking morphs over the years into a sword-wielding barbarian in early



1959



2008

years, a cartoon-like character in the 1960s to a metrosexual in the 1990s.

The interiors contain a plethora of hair and fashion styles. The first issue includes photos of a woodworking exhibit created by all students, and girls' sports, including girls' basketball.

There are also staff portraits that continue throughout all 100 years. Poetry and essay winners' works, and extensive lists of students from former years, are also included. The ensuing years see emphasis on male sports that slowly gives way to the inclusion of girls' sports in the 1970s and equal pages dedicated to school plays and the growing interest in music programs. In 1984, color photographs are introduced for the first time and are used for only the senior class portraits.

The archive is missing the following year books: 1987 and 1997 through the present. If anyone has these books to donate contact Shan Thomas at 437-6486 or email to mthorebarchives@mhtc.net

Timepiece with a Double Story



The Klevens' fancy brass and glass clock recently gifted by Alice Evenson. (MHAHS Museum collections)

In 1911 Iver and Anna Kleven witnessed their Golden Wedding anniversary. The couple's family and friends most certainly gathered for a celebration and presented the pair with a heavy brass mantel clock with beveled glass panels and inscribed base that reads "1861 Mr. & Mrs. I. Kleven 1911." This is no unusual event by today's standards as Golden Wedding celebrations are a common occurrence. However placing this celebration into the timeframe in which this couple spent the greater part of their lives – the last half of the 19th century – we discover a more unique story.

Lewis E. Atherton writes in *The Social Fabric: American Life from the Civil War to the Present*: "Golden Wedding celebrations had great appeal partly because the death rate prevented so many couples from reaching this goal, but also because people liked to think that Golden Weddings proved the greater stability of marriages in small towns. ..." Indeed, life expectancy for men in the settlement period of Southwestern Dane County was approximately age 35.

Much of this was attributed to the sun up to sunset nature of laborious work. Add to this the greater risk of disease, the lack of appropriate medical facilities, and the distance by horse or carriage for a visiting doctor. In 1871 both Anna and Iver took ill, with Iver unable to work for a lengthy period of time and with the couple not fully recovering for more than a year.

Because of their rarity Golden Weddings were certainly newsworthy events that prompted the editors of local papers to expound on the virtues and life accomplishments of the celebrating couple as well as include the aged pair's photograph, usually posing with cake, flowers or gifts received from well-wishers. The entire neighborhood would gather at the couple's home with food and small tokens. In the case of Iver and Anna's clock a group effort was most likely involved with its purchase and presentation.

When Iver and Anna received their gift in 1911 the art of monogramming and engraving objects was popular. The local jeweler or mail order catalogue company inscribed a person's initials or name on such things as tableware, silver and plate metal wares, pocket watches, rings, pendants and in, this case, the base of a clock.

Because of this special inscription, the Klevens' timepiece recently journeyed back home to its origins in Southwestern Dane County. Most wedding and anniversary gifts wind up as everyday objects that long ago lost their connections to special life events. This would have been the case with the Klevens' special timepiece if not for Alice Evenson of Minneapolis. While Alice was helping a family member with personal matters after the death of an

The Mount Horeb Area Historical Society

uncle she noticed the inscription on the base of the clock and realized that the names were those of her great-grandfather and great-grandmother. The uncle's wife asked Alice if she would like the clock after her death. However, the clock wound up at the uncle's son's (Alice's cousin's) house in Florida until he discovered a note taped to the bottom of the time piece that indicated it should go to Alice. He promptly delivered it to Minnesota.

In November Alice contacted the Historical Society offering the clock as a gift. Historical Society curators realized immediately that Alice's offer carried more history with it than that of an anniversary celebration. The clock's original owners happened to be the namesake of a local community, and the founders of a major enterprise in the region.

Readers of *Mt. Horeb Past Times* may recall the January 2013 issue describing the manufacture of wooden tanks and silos in the area. The Iver Kleven who founded that company is the Iver inscribed on the clock. Iver and Anna were married in Valdres, Norway on April 17, 1861. Life was hard for the couple and in 1866 Iver comments in his memoir, "I will prove if we can get there [America], that we can become free people." Relatives supplied the money and the couple arrived in Madison in 1867.

Iver was born in Norway in 1835, and Anna was born in 1838. When the couple received their timepiece he was 76 and she was 73 and they had accomplished much in their first 50 years of marriage. After spending some time in and around Madison, the couple eventually moved to Springdale. In America, Iver learned to be a stone mason and carpenter and eventually joined forces with his sons Knute and Gilbert to build up a sizable lumber, house building and silo and tank manufacturing

business. When the railroad came through in 1881, and a depot site was located near their business, the rail company named the small community after the family. So, this clock not only relays the story of a special milestone event that took place 103 years ago, but also reminds us today of how the unincorporated community of Klevenville came to be named.



Iver and Anna Kleven were married at Bong's Main Church, Aurdal Norway on April 17, 1861. (MHAHS Archives collections)

The
Klevens'
Golden
Wedding
anniversary
clock
engraved
on the
base.



Historical Society Meets, Exceeds Schlecht Challenge

The end of the year became a dramatic waiting game for the Mount Horeb Area Historical Society, but the result was something to celebrate.

One year after Steve and Marianne Schlecht offered a \$250,000 challenge grant for the construction of the new Southwestern Dane County Heritage Center, the Society met – and exceeded – the challenge. By year's end, the \$250,000 was met - and surpassed by \$40,000 - through a grassroots effort by the community, a large list of individuals and organizations within Southwestern Dane County or with ties to the area.

"I'm excited we made it," said Society President Brian Bigler. "I'm more excited about the amount of individuals interested in this project." There were 187 donors who came through to help match the challenge. The total also included a \$15,000 grant from the Mount Horeb Community Foundation. Other donations came at the Society's annual estate sale.

The Society is raising funds for a new \$2.5 million Heritage Center that will house the organization's archives, as well as provide additional display and community space.

The fundraising for the project was kicked off by a \$100,000 donation from Jim Kalscheur's family foundation. Another \$100,000 was received by the Pleasant Rowland Foundation, the charitable organization of the American Girl founder. Neither of those large donations counted toward the match so throughout 2013, the organization and its steering committee worked to raise the funds to match the Schlechts' pledge.

"It was like a football game," Bigler said. "It was like we were watching the score as the donations came in." The donations kept coming as the year ended, and the organization exceeded its fundraising goal by approximately \$40,000. "We knew people would come through and we exceeded the goal," said steering committee member Karla Ott. "That's a huge statement of support."

Despite the success of the fundraising push, the challenge grant and its match are just the first step in raising money to build the facility and create an endowment to maintain it. The organization will continue to raise money, making contact with foundations as well as individuals.

Those interested in more information about the status of the project or future giving can go to www.mthorebhistory.org or call 437-6486.

Summary of Giving January 1-December 31, 2013

Capital Campaign Donors – 2013

Curator (\$1,000,001 or more)

Archivist (\$500,001 to \$1,000,000)

Preservationist (\$100,001 to \$500,000)

Historian (\$50,001 to \$100,000)

Kalscheur Foundation
Pleasant T. Rowland Foundation

Donor (\$35,001 to \$50,000)

Founder (\$20,001 to 35,000)

Researcher (\$10,001 to \$20,000)

Anonymous
Farmers Savings Bank
McNall Family Trust
Mount Horeb Community Foundation
Jonathan Gray Rooney
Mark B. Rooney, in honor of David and Ebenezer Brigham and their Descendants
James Woodburn, Sr.

Friend (\$5,001 to \$10,000)

James and Dixie Burns
Diego and Judy Camacho Family
Patricia Rooney Fannon, in memory of her grandparents,
Charles Ilsey and Anna Gray Brigham
Gehrke and Vanderson Family
Larry Kruckman and Carolyn White
Mount Horeb Rotary Club
Mount Horeb Summer Frolic
John Pare
Jim and Marlene Scott
Bob Woodburn
Peggy and Tony Zalucha

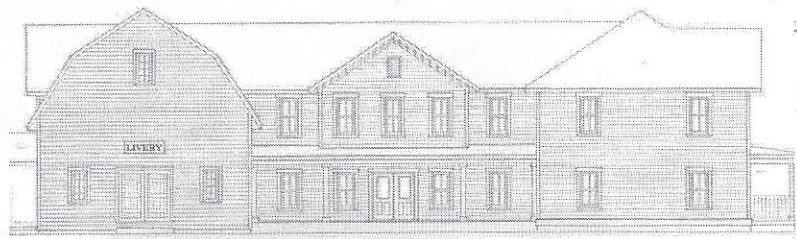

Architectural drawing by Bruce Roth for the proposed Southwestern Dane County Heritage Center building, Front St. view

The Mount Horeb Area Historical Society

Docent (\$1,001 to \$5,000)

David and Janet Andersen
Rayne Arneson and Michael Losenegger
Brian J. Bigler and Ken J. Scott
The Boyden Family
Jim and Shirley Buechner
John and Mary Buechner
Ralph L. Buechner
Jane Burns
LeRoy Collins, in memory of Gladys
Maxine Dimick
Vern and Betty Drape
Rick Field, in honor of Art and Ruby Field
Stephen and Aimee Gauger
Gerald Glaeve dba Glaeve Art and Books
John and Marietta Gribb
Eileen Hanneman and Larry Sromovsky, in memory of Bud,
Lorraine and Richard Hanneman
Karl and Mary Klopotic Family
Gerhard and Sonja Luetschwager
Richard O. Lust/Lust Auction Services, LLC
Sam and Shirley Martin
Sam and Shirley Martin, in memory of Carl and Lucile Brechler
Sam and Shirley Martin, in memory of Scott Beat
Sam and Shirley Martin, in memory of Sara Hirsch
(Underwood)
Sam and Shirley Martin, in memory of Ruth Dahlen Thomas
Willis and Helen Martinson
Miller & Sons
Mound City Bank
Walter H. Naujeck
Tony and Darlene Nowak
Ott Family
John and Karen Ranum
John and Karen Ranum, in memory of Jack Nowka
John and Karen Ranum, in memory of Janice Tollund Gay
John and Karen Ranum, in memory of Elizabeth "Betty" Becker
John E. Schwenn, in memory of Mike and Ruth Schwenn
Glenn and Mary Spaay
Irv and Judy Steinhauer
Vivian Stone
Shan Thomas
Dennis and Joan Thomson
James Tomb
John and Jodie (Roth) Tonner
Jim and Marly VanCamp
Larry and Pat Welo
Roland and Becky Wilson
Wisconsin Online Surplus
Curtis and Deloris Witte
Gary and Connie Jo Zwettler, in honor of
Don and Gertie Henderson
Gary and Connie Jo Zwettler, in memory of Cora Bilse
Gary and Connie Jo Zwettler, in memory of June Burns Gander
Gary and Connie Jo Zwettler, in memory of Jim Murphy
Gary and Connie Jo Zwettler, in memory of Sara Hirsch
(Underwood)

Contributor (Up to \$1,000)

Anonymous (13)
Annette and Jeffrey Anderson, in memory of Delma Woodburn
Shirley Archer
Carl and Lois Arneson
Lonna Arneson
Lonna Arneson, in memory of Cora Bilse
AXA Foundation
Delma L. Baker
Frances Barman-Paulson
Donna Bigler
Joel and Merel Black
Dr. Mark and Jeanne Bohl
Phyllis Boyden, in memory of June Bohn
James/Susan Brice
Johnna Buysse and Thomas Baden
Michael J. and Nancy Thorne Cahill
Scott Chapman
Raymond and Carol Clinton
David and Linda Colby
Douglas B. Cox
Leland Crimmins, in memory of Curt Shutvet
Leland Crimmins, in honor of Richard and Elsie Crimmins
Connie Curran, in memory of Sena Lewis
Lois Dale
Jim and Gloria Davies
Donnelly Foundation, in honor of Brian Bigler
Brian W. Durtschi
Ray and Sherry Einerson
Arthur and Beth Elver
ELC Sewing Ladies
Darryl N. Fargo
Neal and Joan Fargo, in memory of June Burns Gander
David and Patricia Flom
Linda E. Gerke, in memory of Franklin A. Gerke
Linda E. Gerke, in memory of Jim Zeasman
Edward Glover
Eddie and Cheryle Goplin
Linda and Mike Gross
Anita Gurda, in memory of Alma Skindrud
Anita Gurda, in memory of Joseph Brager
Anita Gurda, in memory of Richard F. Hanneman
Anita Gurda, in memory of Joan Zuehlke
Mark and Julie Haebig
Ruth Haglund
Chuck Haig and Tamlyn Akins
Philip and Ruth Halverson
Dorothy Handrick
Hands All Around Quilters, in memory of Jean Clark
Gregg and Susan Harvey
Gertrude Henderson, in memory of Inez Skalet
Gertrude Henderson, in memory of June Burns Gander
Gertrude Henderson, in memory of Jack Nowka
Gertrude Henderson, in memory of Cora Bilse
Gertrude Henderson, in memory of Joe Sutter
Gertrude Henderson, in memory of Jim Murphy
Gertrude Henderson, in memory of Frederick Klusendorf

The Mount Horeb Area Historical Society

Capital Campaign Donors – 2013

Contributor (Up to \$1,000) *continued from page 7*

Gertrude Henderson, in memory of Sara Hirsch (Underwood)
 Meda Heywood
 Duane and Patsy Hofstetter
 Paul and Diane Hooper
 Mary Jane Hull
 T.C. and N.N. Hunt
 Ingleside Manor
 Dorothy Johnson, Janet Beat and Shirley Martin, in memory of
 Jean Hendrickson Hanley
 Mark and Barbara Johnson
 Betty J. Kalbacken
 Lois M. Kaplan
 Shirley P. Keller, in memory of Wallace Keller
 Shirley P. Keller, in memory of Jean Clark
 LaVonne (Bonny) Kellogg
 Ken and Sara Kittleson
 Rose Klir
 John Kuse
 Land O'Lakes, Inc. Foundation
 Lora Lee
 Debra A. Lehner, in memory of Peter Lehner
 Fred Luhman
 Russell and Vergeane Martin
 Sara Ann Mattes
 Sara Ann Mattes, in honor of Arneson/Losenegger Families
 Lucille McKee
 The Mertz Family
 Chuck Misky, in memory of Pauline Misky
 Mark and Becky Mostrom, Richard, William and
 Roderick Skindrud, in memory of Alma Skindrud
 Brad and Roseann Murphy
 R.D. Nelson
 Douglas and Janet Nesheim
 Bruce and Jean Oimoen
 Bill and Muriel Olson
 David Paulson
 Elizabeth and Robert Petrus
 Edward J. Post
 Georgia J. Post
 Premier Cooperative
 Donna J. Read
 Glenn Reinl and Sara Krebsbach
 Melba and Norm Rick
 Pete and Carol Riphahn, in memory of Joyce Judd
 Pete and Carol Riphahn, in memory of Joe Sutter
 Pete and Carol Riphahn, in memory of June Bohn
 Pete and Carol Riphahn, in memory of Sara Hirsch
 (Underwood)
 Renee L. Riphahn
 Max and Betty Rosenbaum
 Sandra S. Roth, in memory of Dean Roth
 Audrey Scheide
 James E. Schmidt
 Steve Schmitt
 Ruth Schulien-Richardson

Beverly M. Schwierske
 Cletus and Jane Schwoerer
 Cathy Scott
 David Sherlock and Jennifer Gottwald
 JoAnn Six, in honor of hiring Bruce Roth, Architect
 Arlen and Elaine Spaanem
 Springdale Inn
 Robert R. Stampfli
 State Bank of Cross Plains
 Shan Thomas and Gerry Glaeve, in honor of Laurie Boyden
 and June Bohn
 Kevin Tvedt
 Mary Lou Underwood
 Pearl V. Vierima
 Teri L. Vierima and David Hoffman
 Mary E. Walsh
 Peter and Mary Waltz
 West Blue Mounds Lutheran WELCA
 Cheryl Wille-Schlesser and Roger Schlesser
 Ron Wirth, in memory of Alma Skindrud
 Women of Mount Horeb Evangelical Lutheran Church
 Ellen W. Wright
 Audrey M. Zander
 Erwin F. Zuehlke, in memory of Joan Zuehlke
 Kathie M. Zwettler
 Sally Zwettler, in memory of Jean Clark



Spring Fundraiser

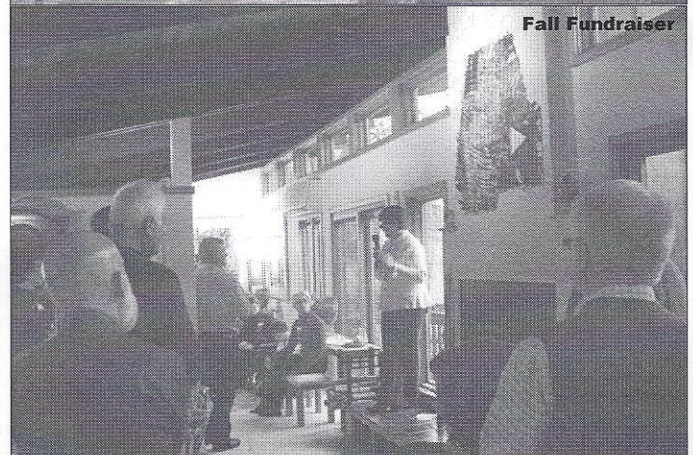

Fall Fundraiser

**2013 Capital
 Campaign
 fundraisers
 hosted by
 Tony and
 Peggy Zalucha
 at their home
 in Mt. Horeb**

Photo by Connie Jo Zwettler

Photo by Jane Burns

The Mount Horeb Area Historical Society

Archives and Museum Collections Donors

Eleanor Arneson
Jim Bakken
Brian Bigler
Robert Birmingham
Merel Black
BMO Harris Bank
June Bohn Estate
Brynn Bruijn
Ralph Buechner
Jane Burns
Marilyn Collins
Sharon Collins
Bill Crawford
Tim Deneen
Janice DeWitt
Tom and Ruth Dobson
Beth Elver
Richard Evenson
David Ewing
Patti Fannon
Alwyn Fitzgerald
Sally Flood
Elynor Gabner
Susan Gilchrist
Janet Gilmore
Gerald Glaeve
Ed Goplin
John and Marietta Gribb
Marlyn Grinde
Betty Grundahl and Family
Ruth Haglund
Eileen Hanneman
Phil and Ruth Halverson
Gertie Henderson
Jim Hilbrand
Steve Hopkins
Lois Jacobson Kaplan
Mick Kennedy
Jill Knuteson
Winnie Lacy
Gordon Lamberty and Family
Sharon Lee
Winnie Losenegger
Patricia MacLean
Hazel Maloney
Sam and Shirley Martin
Andrea Miller
Mt. Horeb High School
Mt. Horeb School District
John Murphy
Phyllis Murphy
Norwegian American Genealogical Library
Oregon Historical Society
Donna Read
Monica Reeve

Pete and Carol Riphahn
Mark Rooney
Jack Rue
Audrey Scheide
Bob and Sharon Schiefelbein
Steve Schmitt
Anna Schult
Ken Scott
Mitzi Skalet
Bill Skindrud
Fred and Mary Smith
Sandra Stanfield
Don Stewart
Vivian Stone
Shan Thomas
Dennis and Joan Schurch Thomson
Robert Tollund
Jane Topper
Village of Mt. Horeb
Richard Went
Tim White
Scott Winner
Bob and Nan Woodburn
Connie Jo Zwettler
Sally Zwettler

Contributions to General Fund

Gerry Glaeve and Shan Thomas
Delma Larson
MHHS Class of 1941
James and Andrea Mueller
Peggy L. Peterson
Saundra Roth

Contributions to Museum/Society Operations Fund

Beverly Briggs
Don Dalessio and Julie Hayward
Finn Gunderson, Lois M. Kaplan
Vern and Sylvia Lowell
Kathy O'Donnell
Philip and Susan Krejci
Francis Barman Paulson
Ed Post
Vivian Stone
Pearl Vierima

Contributions to Contingency Fund

Lois M. Kaplan
Vivian Stone

2013 Memberships

New Individual:

Suzanne Birrenkott
Alan Davidson
Linda Gerke
Kae Evenson Johnson
Robert Ranum Tollund
David Stenseth

New Household:

Merel Black
Scott Edmundson
Eileen Hanneman
Alex and Karen Hobson

New Contributing:

Mathew Marty and Katherine Wiggins
Ron and Jennifer Spielman

Contributing:

Ruth Schulien-Richardson
David Sherlock and Jennifer Gottwald
Donald and Carol Schwarz

Sustaining:

Audrey Scheide

2013 Memorial Contributions

In Memory of Scott Beat

Max and Betty Rosenbaum

In Memory of Elizabeth "Betty" Becker

Ron Wirth

In Memory of Cora Spaanem Bilse

Alan Bilse and Beth Ann Elver, Dave and Laurie Boyden, Maxine Dimick, Neal and Joan Fargo, Bernice Hughes and Family - Jane, Rosemary, David, Carol, Rita and Diane, Lucille Stugard McKee, Dr. James Jones and Bernadine Jones, Gordon and Margie Kahl, Paul and Dawn Kellesvig, Peter and Ellen Lesar, Sam and Shirley Martin, Doug and Janet Nesheim, Sandra Roth, Jo Ann Six, Mary Lou Underwood, R. C. Wendt, Ron Wirth

In Memory of June Bohn

Dave and Laurie Boyden, Marlyn Grinde, Mary Jane Hull, Tony and Darlene Nowak

In Memory of Mary Ann Boley

Dave and Laurie Boyden

In Memory of Jacqueline Brown Clay

Marlyn Grinde, Joan Roob

In Memory of Lavonne Collins

Mary Lou Underwood

In Memory of Olga Edseth

Betty J. Kalbacken

In Memory of John Foley

Eddie and Cheryle Goplin

In Memory of Franklin Gerke

Jane Burns

In Memory of Ernest H. Goebler, Jr.

Ron Wirth

In Memory of Dorothy Peterson Handel

Sandra Roth, Jo Ann Six

In Memory of Jean Hanley

Mt. Horeb High School Class of 1946, Max and Betty Rosenbaum, Mary Lou Underwood

In Memory of Fredric "Bud" Hanneman

Sam and Shirley Martin, Ron Wirth

In Memory of Richard Hanneman

Pete and Betty Brechler, Sam and Shirley Martin, Mary Thomas, Dick Wendt

In Memory of Sara Underwood Hirsh

Le Roy Collins, Steve and Aimee Gauger, Hazel Herman, Gordon and Margie K. Kahl, Russell and Vergene Martin, Tony and Darlene Nowak, Sandra Roth, Jo Ann Six, June Underwood, Ron Wirth

In Memory of Mitzi Johnson

Dave and Laurie Boyden, Le Roy Collins

In Memory of Joyce Judd

Elva Jeanne Hanna

In Memory of Bill Kvernen

Ron Wirth

In Memory of Alice Molloy

Le Roy Collins

In Memory of Evelyn M. Monum

Pete and Betty Brechler, Sam and Shirley Martin, Mary Thomas, Dick Wendt, Ron Wirth

In Memory of Helen Moyer

Le Roy Collins

In Memory of James W. Murphy

Le Roy Collins, Sam and Shirley Martin, Ron Wirth

In Memory of Adeline Jane Nelson

Marlyn Grinde

In Memory of Jack Nowka

Sam and Shirley Martin

In Memory of Delbert H. Rickli

Ron Wirth

In Memory of Leo Ryan

Le Roy Collins, Mt. Horeb High School Class of 1946, Betty Ryan, Gary and Connie Jo Zwettler

In Memory of Glenn Schroeder

Eddie and Cheryle Goplin

In Memory of Don Schultze

Francis and Sharon Collins

In Memory of Inez Skalet

Jo Ann Six

In Memory of Bernice Stratman

Ron Wirth

In Memory of Joe Sutter

Le Roy Collins, Eddie and Cheryle Goplin, Ron Wirth

In Memory of Norman Thomson

Marlyn Grinde

In Memory of Lois Wendt

Mary Lou Underwood

In Memory of Joanne Bischoff Wirth

Nancy Albert, Le Roy Collins

In Memory of Ellen Wright

Max and Betty Rosenbaum

In Memory of James Zeasman

Ken and Sara Kittleson, Rosemary Zeasman

Correction from 2012

In Memory of Neal Thomas Fosshage

Ron Wirth

The Mount Horeb Area Historical Society

THANK YOU

The Board of Directors would like to pass along its appreciation to all the volunteers who make everything happen in front of and behind the scenes of the Historical Society, from hosting at the Museum desk, to the archives, to building and grounds maintenance. Additional thanks to the members of the Capital Campaign Steering Committee and the staff, Museum Director Laurie Boyden and Archivist Shan Thomas. The Historical Society absolutely could not function without your generosity and sense of public and community pride.

MUSEUM

Janet Anderson
Eleanor Arneson
Carolyn Bierman
Dave Boyden
Phyllis Boyden
Lois Dale
Beth Elver
Cheryle Goplin
Don Gordon
Marietta Gribb
Gertie Henderson
Mary Jane Hull
Dolly Juhlin
Shirley Martin
Doug Nesheim
Tony & Darlene Nowak
Kathy O'Donnell
John Pare
Lucy Ramshaw
Donna Read

Darlene Reeson

Carol Riphahn
Vicki Rosenbaum
Joyce Schultze
Jane Schwoerer
Vivian Stone
Mary Sutter
Anne Swiggum
Teri Vierima
John Widdecombe
Vicki Widdecombe
Connie Jo Zwettler

CAPITAL CAMPAIGN STEERING COMMITTEE

Brian Bigler
Larry Kruckman
Darlene Nowak
Karla Ott
Tony Zalucha

ARCHIVES

Caitlin Besadney
Merel Black
Brynn Bruijn
Gerald Glaeve
Ruth Haglund
Doug Nesheim
Doug Norgord
Karen McKay
John Pare
Teri Vierima

Time to Renew Your Membership

We would like to keep you up-to-date on all the Historical Society information, events and activities by once again renewing your annual membership. Your renewal will ensure that you continue receiving the Mt. Horeb Area Past Times newsletter with all the information for the year in addition to fascinating articles and photos of the area's history. Your membership renewal form can be found at the bottom of this page. Please fill it out and send it along with your payment.

Your annual membership expiration date is printed on the mailing label on the back page of the newsletter. Please check to see if you are up-to-date through Jan. 15 or beyond. If not, your membership is due.

Donations can also be made on the form to the much needed Museum/Society Operations fund and a Contingency fund that sets aside monies for any unforeseen Society expenses. Donations will continue to be sought for the Capital Campaign building fundraising effort as the final goal is still to be met.

Your continued support of the Society allows us to collect and preserve the history of Southwestern Dane County.

New Members Welcome!

January 2014 newsletter contributors: Brian Bigler, Laurie Boyden, Merel Black, Jane Burns, Marlyn Grinde, Darlene Nowak, Donna Read, Shan Thomas; edited by Jane Burns with current photography by Laurie Boyden, Jane Burns and Connie Jo Zwettler; historic photos and archival materials from the collections of the Mt. Horeb Area Historical Society

Annual Membership in the Mt. Horeb Area Historical Society

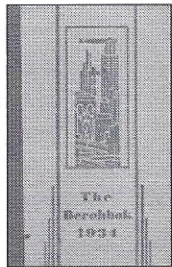

New Member Renewal

Name _____

Address _____

City _____ State _____ Zip Code _____

Phone () _____ E-mail _____

Membership Levels (Renewal to be paid annually in January)

\$20 Individual \$35 Household \$75 Contributing \$150 Sustaining \$500 Patron

These levels will be acknowledged annually in the year end newsletter

Additional Donations To:

Museum/Society Operations \$ _____ Contingency Fund \$ _____ Building Fund \$ _____

Mail to: Mt. Horeb Area Historical Society, 138 East Main St., Mt. Horeb, WI 53572 All contributions are tax deductible.

We Depend On You! Thank you for your support.

Mt. Horeb Area Historical Society
138 E. Main St.
Mt. Horeb, WI 53572-2195
www.mthorebhistory.org

BREAKING NEWS –
Capital Campaign Fund
Challenge Match
Exceeded
See Page 6

**Mt. Horeb Area Historical Society
Board of Directors**

Brian J. Bigler-President
Tony Zalucha-Vice President
Ruth Haglund-Secretary
Bill Thousand-Treasurer

Jane Burns
Johnna Buysse
Marlyn Grinde (*Honorary*)
Shirley Martin
Doug Nesheim
Darlene Nowak
John Pare
Peter Riphahn
Lee Underwood
Connie Jo Zwettler

**Capital
Campaign
Steering
Committee**

Brian Bigler
Larry Kruckman
Darlene Nowak
Karla Ott
Tony Zalucha

Curators:

Marlyn Grinde
Lee Underwood
Donna Read-Archaeology
Marietta Gribb-Costumes, Textiles, Dolls

Operations:

Laurie Boyden-Museum Director/Newsletter
Jane Burns-Newsletter Editor
Shan Thomas-Archivist (for appt. 437-1147)

Archives Hours:

Archival Collections Research/Drop off
Mondays Noon-4:00
Museum Collections Research/Drop-off
2nd & 4th Wednesdays each month 12:30-3:00
3rd floor of the Municipal Building
138 E. Main St., Mt. Horeb, WI
608-437-6486

Mt. Horeb Area Museum and Shop
Open May - December
Hours: Friday and Saturday 10 a.m. - 4 p.m.
Sunday 12:30 p.m. - 4 p.m.
100 S. 2nd Street, Mt. Horeb, WI
Free Admission

October 2013 Sale Success

The popular sale proved once again to be just that with a total of \$4,600 for the day. The proceeds were added to the building fund.

The Board of Directors would like to extend a huge thank you to these additional individuals for their contributions:

Janice DeWitt/Edna Aavang estate, Gertie Henderson, Darlene Nowak, Barb Schermetzler, Vivian Stone, Connie Jo Zwettler

Future sales will always be a possibility, so when cleaning out attics, basements, closets, sheds and barns, please keep us in mind as we accumulate items for several years. The sale takes place on the Saturday of the Fall Heritage Festival just off of Main Street in the alley next to the Hoff Building in downtown Mt. Horeb – behind the museum

Sought are quality household items, jewelry, small pieces of furniture, antiques, collectibles, old dolls and toys, vintage clothing, canning supplies, lamps, old cameras, vintage and contemporary books, old postcards, unusual paper items, crocks, primitives, antique radios, vintage magazines, rugs and runners, glass items, artwork, framed items and more.

Because of past experiences the Society cannot accept the following items for the sale: mattresses, computers and other electronics, televisions, newer children's toys, strollers, cribs, car seats, skis, contemporary clothing, shoes, large pieces of furniture, appliances, lawnmowers, snow blowers, etc.

To donate call the Historical Society office at 437-6486. Small items may be dropped off at the Museum, but please call first.

Don't forget to renew your membership for 2014!

F. Y. I. FOR CURRENT MEMBERS: Your membership expiration date is printed on the mailing label of this newsletter. Please check to see if you are up to date through Jan. 15 or beyond. If not, your membership is due. Please fill out the form on page 11 and send it with your payment. We appreciate your renewal and don't want you to miss a single issue of our newsletter or any important information about Historical Society events.